

VanMap: Bringing Geographic Data to Desktops



Jonathan Mark
GIS Manager
City of Vancouver

Presented at URISA BC's
Solutions Seminar
November, 2002

What is VanMap?



- VanMap is an easy-to-use viewer of data that has a geographical reference
- Data is organized in layers that can be turned on and off individually or in groups

VanMap's Data Includes



- addresses and property lines
- zoning (and access to the bylaw)
- City and non-City utilities
- public places (schools, libraries, etc.)
- aerial photographs
- business and dog licenses
- ownership and assessed values
- many other layers

VanMap's Functionality



- Zooming in and out and panning
- Reports
- Notifications
- Measure distances
- Zoom to specific address and locations
- Copy and paste maps
- Print maps

VanMap's Business Drivers



- Desire to provide easy access to GIS and other spatial data
- Desire to support staff in their contact with the public because much of the contact is about property-related issues
- Desire to improve communication with the public

VanMap's Business Drivers



- Desire to improve service and facilitate self-service
- Desire to work with and support other City web initiatives such as Community Web Pages and Road Ahead
- Desire to promote enterprise approach to GIS

VanMap Availability



■ Staff VanMap

- v1 in September, 1999
- v4 in September, 2001
- several incremental and data releases since

■ Public VanMap

- v1 for Intel in 5/01 and for Macs in 8/01
- v2 for Intel and Macs in 2/02
- VanMapLite in 10/02
- One of the popular parts of the City's site

Issues We Dealt With For Public Release



- Freedom of Information and Protection of Privacy Act limitations
- Usefulness to the public
- Impacts on staff
- Risk considerations
- Data sales implications

Key VanMap Benefits



- VanMap provides a visual map context for viewing data
- VanMap integrates data from a variety of City sources and applications
- VanMap provides access to more current data
- VanMap provides data sharing and encourages cleaner data
- VanMap provides the public with much of the same data that staff use to answer their questions

VanMap Directions



- Staff: continued incremental releases with additional data and functionality
- Staff: specialized versions of VanMap for specific work groups
- Public: incremental releases with additional data
- Continued integration with other City web initiatives
- Continuous improvement of usefulness and usability

What Makes VanMap Different



- VanMap is very rich in data
 - Staff version has over 90 layers of data
- VanMap is available to staff and the public
- Public version works with Internet Explorer, Netscape, and Macs
- VanMap is integrated with other City web initiatives
- VanMapLite is a “plug-in free” version

VanMap



- Give VanMap a click. It's revealing.
- Information on a new scale.

Contact Information



- Jonathan Mark
- GIS Manager, City of Vancouver

- 604-873-7987
- jonathan_mark@city.vancouver.bc.ca
- www.city.vancouver.bc.ca

Demonstration

A thick, horizontal yellow brushstroke underline that spans most of the width of the slide, positioned directly below the title.

VanMap public version - Microsoft Internet Explorer

File Edit View Favorites Tools Help

Back Forward Stop Refresh Home Search Favorites History Mail Print

Introduction Go [Map Tools] VanMap home CITY OF VANCOUVER

- City Boundary
- Reference Streets
- Community Centres
- Libraries
- Schools
- Fire Halls
- Parks
- Non-Market Housing
- GVRD Trunk Sewers
- Water Large Valves
- Water Transmission Main
- Water Transmission Main
- Property Use Inspection [
- Zoning Districts
- Local Areas
- Facet Grid Polygons

© CITY OF VANCOUVER
Data quality not guaranteed

Done Internet

Detailed description: This is a screenshot of a web browser displaying the 'VanMap' application. The browser window title is 'VanMap public version - Microsoft Internet Explorer'. The address bar shows 'Introduction' and the page content includes the 'CITY OF VANCOUVER' logo and a list of map layers. The map itself shows the city of Vancouver with various local areas outlined in orange. A legend on the left side of the map allows users to toggle different data layers on and off. The 'Local Areas' layer is currently selected and highlighted with an orange square. The map includes labels for various neighborhoods such as West End, Downtown, Grathcona, West Point Grey, Kitsano, Fairview, Mount Pleasant, Arbutus-Ridge, Shaughnessy, Riley Park, Renfrew-Collingwood, Dunbar-Southlands, Kerrisdale, Carridge, Sunset, Victoria-Fraserview, Marpole, and Klamey. A north arrow is visible in the upper left corner of the map area. The browser's status bar at the bottom shows 'Done' and 'Internet'.

Introduction

Go



VanMap home

CITY OF VANCOUVER

- Community Centres
- Libraries
- Schools
- Fire Halls
- Parks
- Non-Market Housing
- Property Information Indic
- GVRD Trunk Sewers
- Water Large Valves
- Water Transmission Main
- Water Transmission Main
- Street Intersections
- Private Streets
- Street Names
- Street Segments
- 2-Metre Contour Lines
- 10-Metre Contour Lines
- Building Footprints (Down
- Property Use Inspection I
- Zoning Districts
- Local Areas
- Facet Grid Polygons

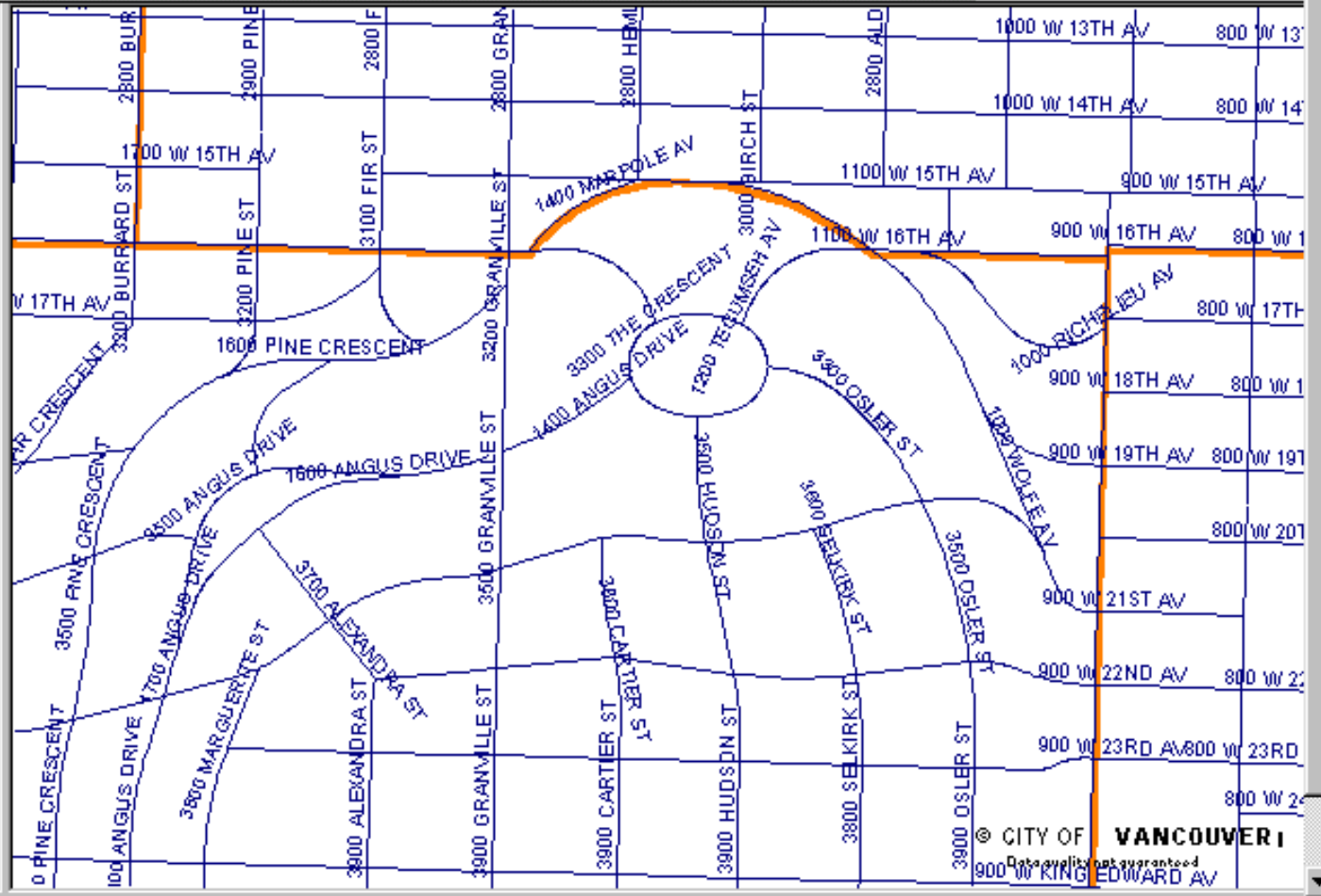

- Community Centres
- Libraries
- Schools
- Fire Halls
- Parks
- Non-Market Housing
- Property Addresses
- Property Information
- Property Address No
- Property/Lot Lines
 - Lot Line
 - Property Line
 - + Tie Line
- Block Outlines
- GVRD Trunk Sewers
- Sewer Manholes
- Sewer Mains
- Water Valve Labels
- Water Large Valves
- Water Hydrant Labels
- Water Hydrants

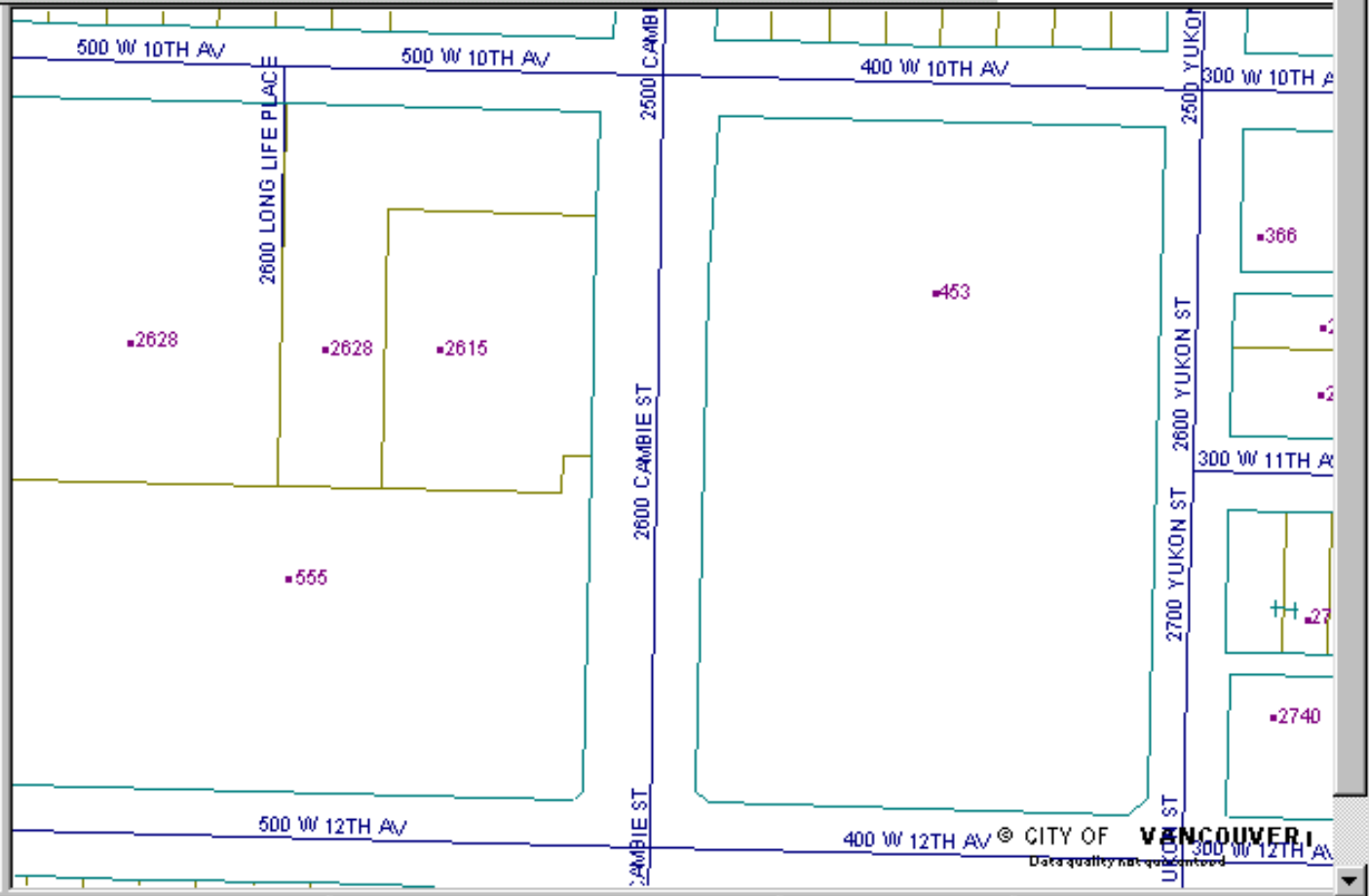



Introduction

Go



VanMap home

CITY OF VANCOUVER

- GVRD Trunk Sewers
- Sewer Manholes
- Sewer Mains
- Water Valve Labels
- Water Large Valves
- Water Hydrant Labels
- Water Hydrants
- Water Distribution Mai
- Water Distribution Mai
- Water Transmission M
- Water Transmission M
- Street Intersections
- Private Streets
- Street Names
- Street Segments
-
- 2-Metre Contour Lines
- 10-Metre Contour Line
- Building Footprints (Dc
- Property Use Inspecti
- Zoning District Labels
- Zoning Districts
- OrthoPhotos
- Street Grid Data

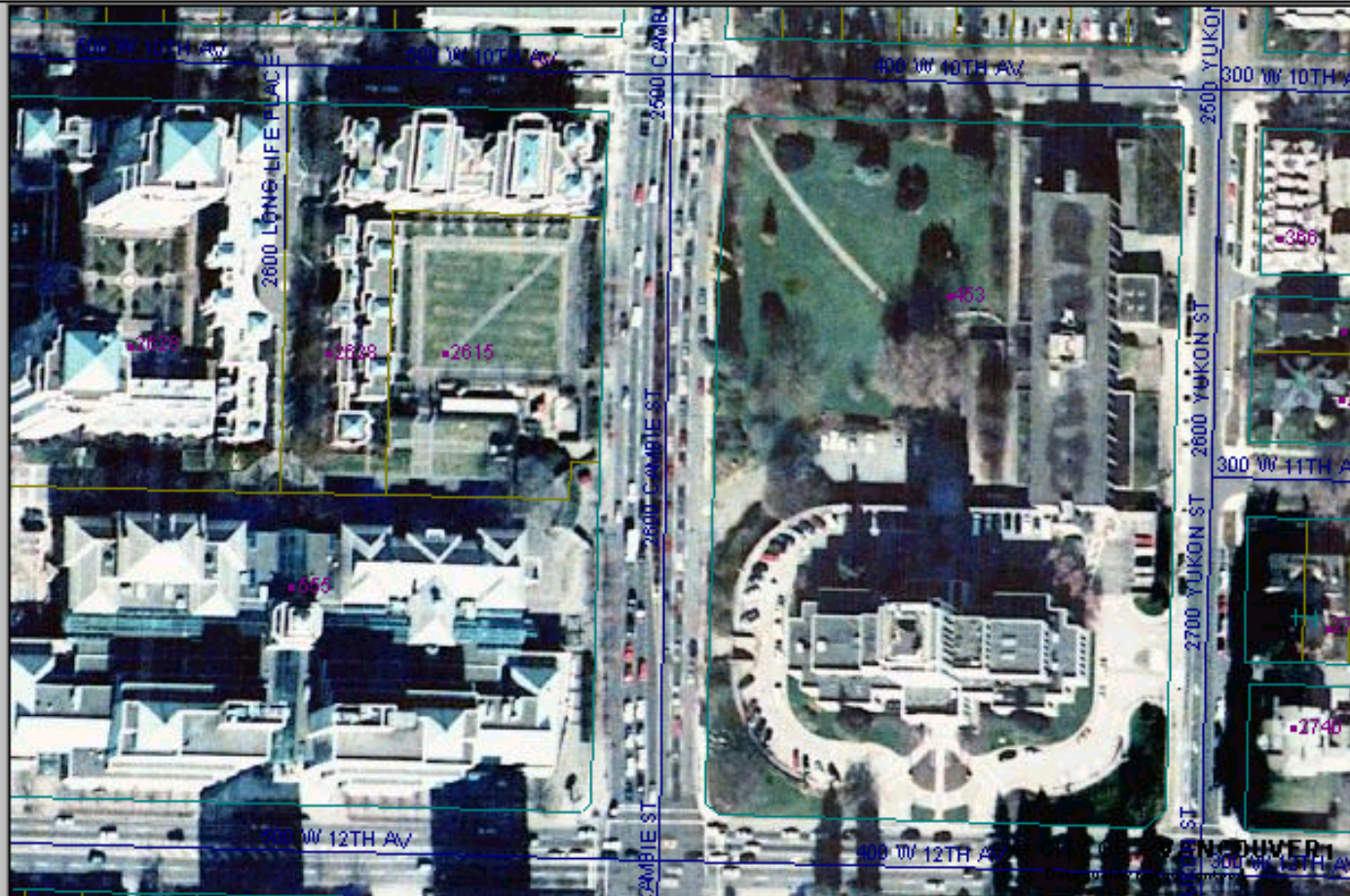

Zoom Go To Choices

Zoom Goto [X]

Location

Category : Parcel Main Address (e.g. 453 w 12th)

Location :
Hundred Blocks (e.g. 500 e 12th)
Parcel Main Address (e.g. 453 w 12th)
Parcel Related Address (e.g. 4354 fraser)
Places (e.g. BC Place/ City Hall)

Zoom to width : 0.500 (Km)

Select a category then enter a location to goto...

OK Cancel Help



VanMapLite Help

Click map to: Zoom In Zoom Out Recenter Identify



Layer List		
Layer Name	Visible	Symbol
North Arrow	<input checked="" type="checkbox"/>	
City Boundary	<input checked="" type="checkbox"/>	
Local Areas	<input type="checkbox"/>	
Shore Lines and Sea	<input checked="" type="checkbox"/>	
Group/Layer List		
Layer/Group Name	Visible	Symbol
GROUP: Election 2002	<input checked="" type="checkbox"/>	
Voting Division	<input checked="" type="checkbox"/>	
Voting Places	<input type="checkbox"/>	
Voting Boundary	<input checked="" type="checkbox"/>	
GROUP: Public Places	<input type="checkbox"/>	
Community Centres	<input checked="" type="checkbox"/>	
Fire Halls	<input checked="" type="checkbox"/>	
Libraries	<input checked="" type="checkbox"/>	
Parks	<input type="checkbox"/>	
Schools	<input type="checkbox"/>	
GROUP: City Projects	<input type="checkbox"/>	
City Projects (Sites-...)	<input checked="" type="checkbox"/>	

